

The Lake Lothing (Lowestoft) Third Crossing Order 201[*]



Lake Lothing
**THIRD
CROSSING**

Document SCC/LLTC/EX/130: Rights of Way and Access Plans (Sheet 1 of 2)

Planning Act 2008

The Infrastructure Planning (Applications: Prescribed Forms and Procedure) Regulations 2009

The Infrastructure Planning (Examination Procedure) Rule 2010

PINS Reference Number: TR010023

Author: Suffolk County Council

Document Reference: SCC/LLTC/EX/130

Date: May 2019

This page is intentionally left blank

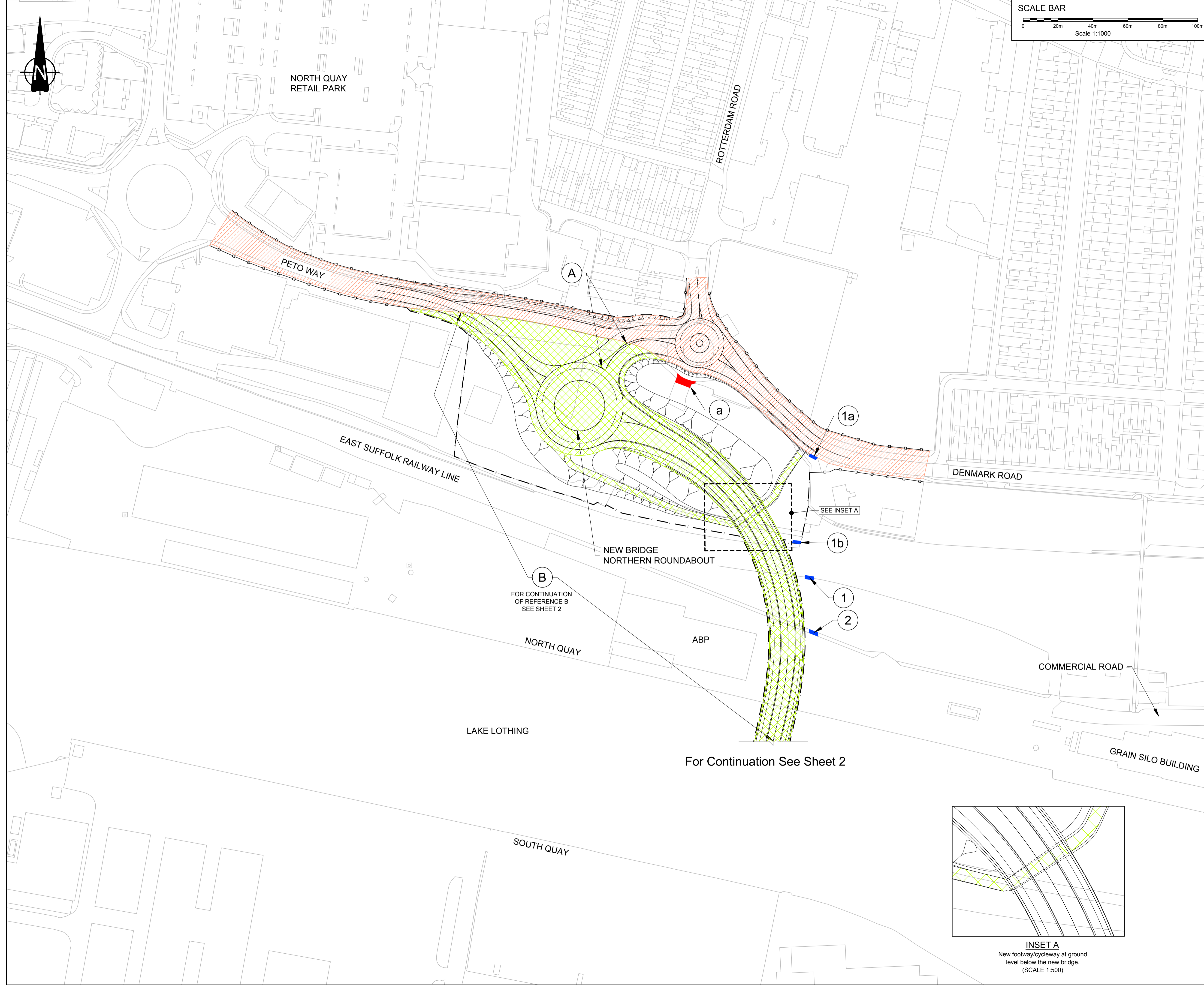
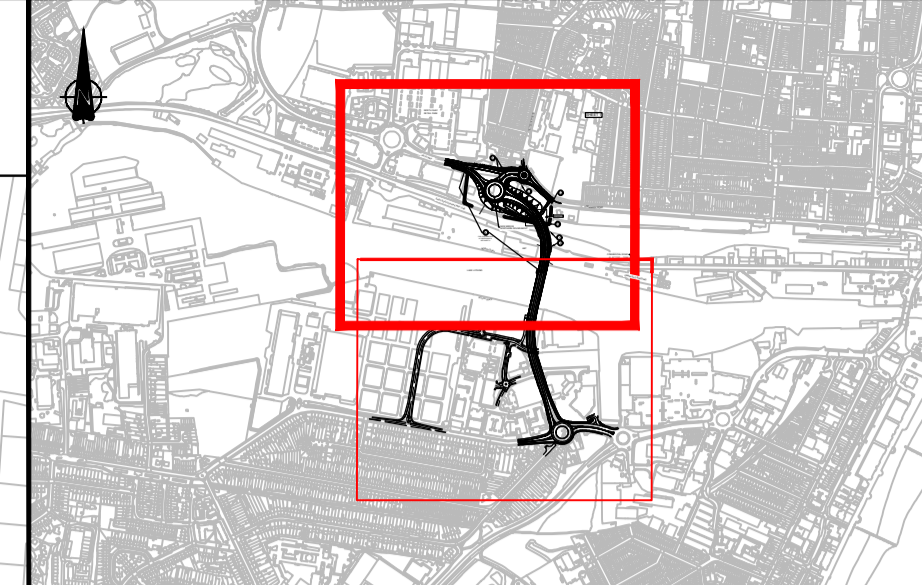
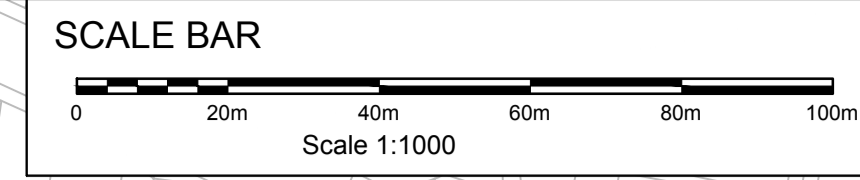
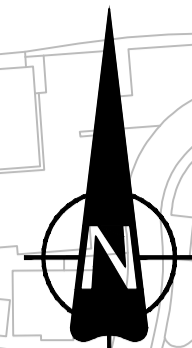

KEY

- Earthworks
- Proposed highway
- Private means of access to be stopped up
- New Highway carriageway (and footway / cycleway where applicable)
- Improved Highway carriageway (and footway / cycleway where applicable)
- New private means of access
- Private means of access to be stopped up
- New private means of access
- New highway
- Existing highway boundary
- Proposed / new highway boundary

- NOTES**
- All dimensions are in metres unless stated otherwise.
 - These rights of way & access plans should be read alongside other plans and documents in the development consent order application, in particular Schedule 4 (permanent stopping up of highways and private means of access).
 - The design is shown for illustrative purposes only.

Mapping reproduced by permission of Ordnance Survey on behalf of HMSO.
 © Crown copyright and database rights 2017. All rights reserved.
 Ordnance Survey licence number 100023395
 Contains OS data © Crown copyright and database rights 2017.

P01 MB NH SG 26.04.19
 FOR DCO EXAMINATION - DEADLINE 9

REVISION	DRAWN	CHECKED	APPROVED	DATE



PROJECT TITLE
 Lake Lothing
THIRD CROSSING

DRAWING TITLE
 RIGHTS OF WAY & ACCESS PLANS
 REGULATIONS 5(2)(k) & 5(2)(o)
 SHEET 1 OF 2

DRAWING STATUS
 FOR DCO SUBMISSION

DRAWN	CHECKED	APPROVED	AUTHORISED	SUITABILITY
TS	NH	CC	JB	S4

SCALE @ A1 SIZE: 1:1000 DATE: 13/06/18 REVISION: P01

DRAWING NUMBER

Project	Originator	Volume
1069948-WSP-HAC-LL-DR-CH-0002		
Location	Type	Role

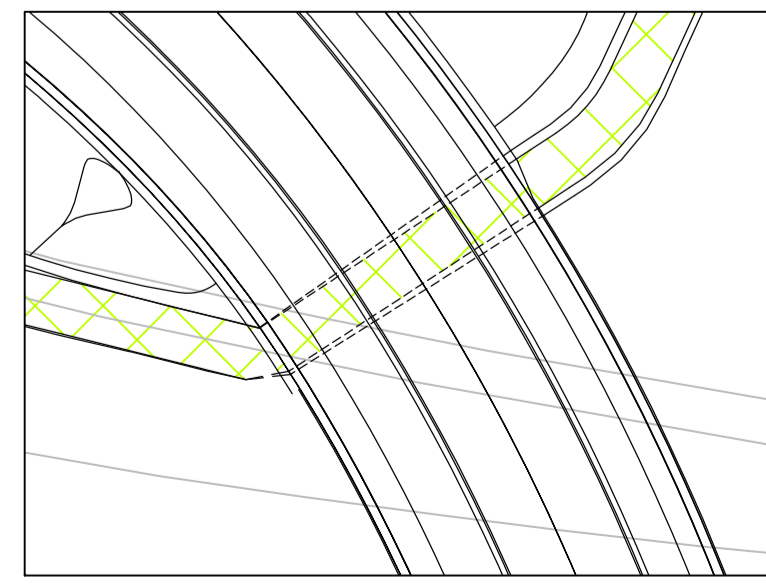

INSET A
 New footway/cycleway at ground level below the new bridge.
 (SCALE 1:500)

B
 FOR CONTINUATION OF REFERENCE B SEE SHEET 2

For Continuation See Sheet 2